

iHome®

Model iP39
**FM stereo system
with dual timers
for iPhone and iPod**

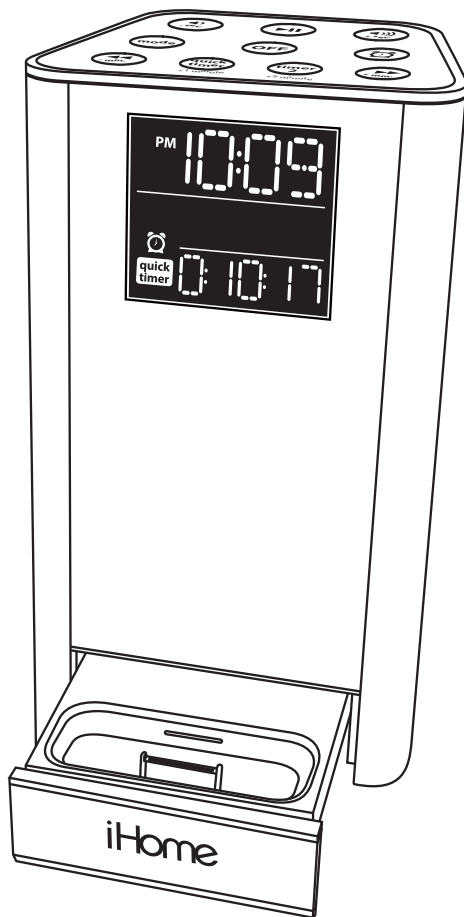

Questions? Visit www.ihomeaudio.com

Table of Contents

Quick Start	1
Controls and Indicators / iP39 Display	2
Getting Started	3
Connect AC adaptor, Install Clock Backup Battery, Install iPod/iPhone insert	
Setting Up the iP39	4
Setting the Time and Calendar using iPhone/iPod Time Sync	
Setting Time and Calendar Manually	
Timer Operation	4-5
Setting the Quick Timer, Setting Timer 2	
Using the Alarm	5
Setting the Alarm, Review, Arming and Disarming Alarm	
Resetting the Alarm to Come on the Next Day, Sure Alarm	
Charging your iPod/iPhone and USB Device	6
Listening to iPod/iphone	6
Listening to FM Radio	7
Setting up the Antenna, Tuning and Playing the Radio	
Setting FM Radio Frequency/Range touse iP39 in Other Countries	
Using the Aux Line-In Jack with other Audio Devices	7
A Consumer Guide to Product Safety	8
Troubleshooting	9

Maintenance

- Place the unit on a level surface away from sources of direct sunlight or excessive heat.
- Protect your furniture when placing your unit on a natural wood and lacquered finish. A cloth or other protective material should be placed between it and the furniture.
- Clean your unit with a soft cloth moistened only with mild soap and water. Stronger cleaning agents, such as Benzine, thinner or similar materials can damage the surface of the unit.



This product bears the selective sorting symbol for waste electrical and electronic equipment (WEEE).

This means that this product must be handled pursuant to European Directive 2002/96/EC in order to be recycled or dismantled to minimize its impact on the environment.

For further information, please contact your local or regional authorities.



Electronic products not included in the selective sorting process are potentially dangerous for the environment and human health due to the presence of hazardous substances.

iP39 Quick start

1: Connect to AC power

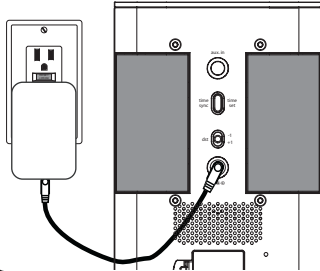

Attach AC adaptor cable to the DC jack on back of the iP39 and plug the other end into a working wall socket to play and charge iPhone/iPod and to provide power to the USB port.

2: Access slide-out dock

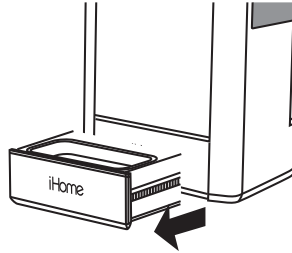

Press on the dock door on the front of the unit to release the universal dock. Push dock back into unit when not in use.

3: Dock iPhone/iPod

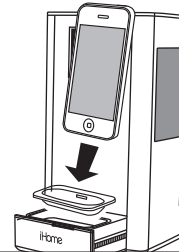

Select the proper insert for your iPhone or iPod from the table below and place in dock. Gently place iPhone/iPod into dock (iPhone/iPod must not be in a "skin" or case). iPhone/iPod will charge while docked. Press the Play Button on the iP39 to play your iPhone/iPod.

Use this insert

iPhone 3G
Insert 15

iPod touch 2G
insert 16

iPod nano 5G
insert 18

For this iPhone/iPod

iPhone 3G/3GS

iPod Touch 2G

iPod nano 5G

NOTE: If you do not have an insert for your iPhone/iPod, please visit www.ihomeaudio.com or call iHome toll free at 800-288-2792 to purchase one.

4: Time

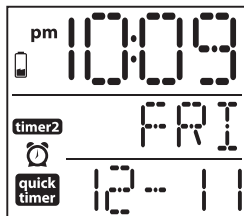

- To use time sync, dock your iPhone/iPod and press the **Time Sync/Time Set Button**. The unit will sync to the time on your iPhone/iPod.
- To set time manually, move the **DST switch** on rear of unit to +1 or -1 (adds or subtracts an hour for daylight saving time or standard time).
- Press & hold the **Time Sync/ Time Set button** on the back of unit until the time display flashes. Press the ◀ / ▶ buttons to set the current time.
- Press the **Time Sync/ Time Set button**. The year display flashes. Press the ◀ / ▶ buttons to set the current year.
- Press the **Time Sync/ Time Set button**. The date flashes. Press the ◀ / ▶ buttons to set the current date and day.
- Press the **Time Sync/ Time Set button** to confirm settings.

Controls and Indicators

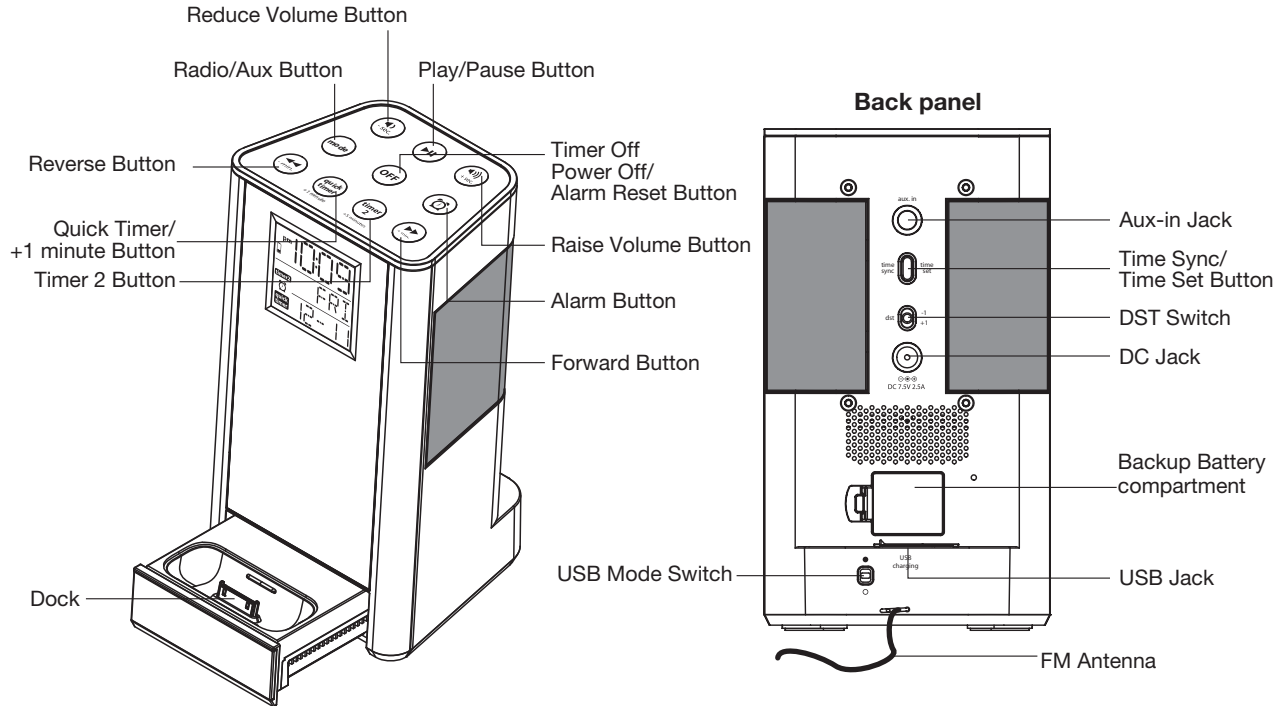

iP39 Display

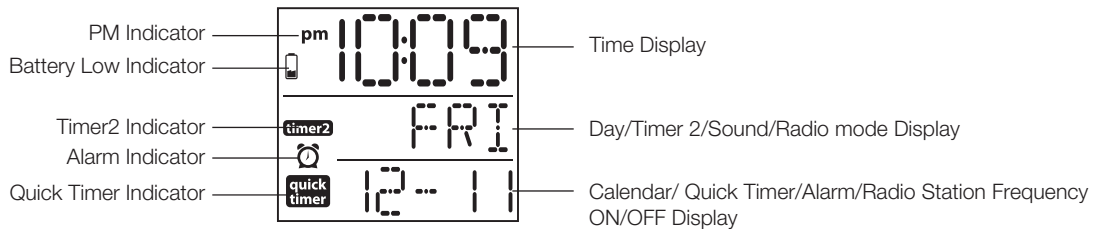

Getting Started

Thank you for purchasing the iP39. Designed specifically to work with your iPhone and iPod, this system provides high quality audio performance that brings out the best in your music and lets you wake, sleep or even cook to it. Please read this instruction carefully before the appliance is operated and keep it for future reference.



Connect AC Adaptor

Connect the AC adaptor cable plug into the DC jack on the back of the system, then plug the AC adaptor into the wall outlet.

Install Clock Backup Battery

The iP39 uses a CR2032 battery for backup to provide continuous alarm operation and clock settings in the event of a power failure. If the Backup Battery has been installed and a power failure occurs or the AC cord is accidentally disconnected, the display backlight will not remain lit, but current time and alarm time settings will be temporarily maintained. Otherwise, you must reset the time and alarm settings. The battery was included in the package with this instruction manual.

1. Please make sure the AC adaptor is connected. Otherwise all settings may be lost during battery replacement.
2. Open the backup battery compartment door located on the rear of the unit.
3. Insert a new CR2032 battery by easing it under the tabs in the battery well and pressing down. Make sure the side marked + is facing up. Close the compartment door.

Note: The  **Icon** is located at the left side of clock display. When battery is low and needs to be replaced, the “**Battery Low**”  icon will flash.

4. Close the compartment cover.

Note: Make sure you dispose of battery properly (see your local regulations).

WARNING: Lithium batteries can explode or cause burns if disassembled, shorted, recharged, exposed to water, fire, or high temperatures. Do not place loose batteries in a pocket, purse, or other container containing metal objects, mix with used or other battery types, or store with hazardous or combustible materials. Store in cool, dry, ventilated area. Follow applicable laws and regulations for transport and disposal.

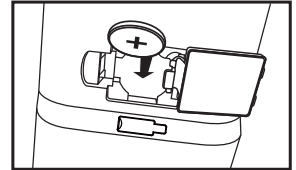

Install iPod/iPhone Inserts

Your iP39 comes with a set of inserts to ensure your iPhone or iPod fits properly in the dock found at the foot of the system. To place an insert:

1. Push dock drawer to access dock
2. Select the insert for your iPhone/iPod (see table on page 1).
3. Gently press the iPhone/iPod insert into the dock.
4. Carefully place your iPhone/iPod into the dock. The iPhone/iPod must not be in a case or “skin”.
5. To remove/replace an insert, first remove your iPhone/iPod then press down the insert latch, grip the insert and pull gently upwards.

Setting Up the iP39

Setting the Clock

Setting the Time and Calendar using iPhone/iPod Time Sync

Time sync mode allows you to sync the iP39 to the time and calendar from your iPhone or recent models of iPod like iPod Touch, iPod Nano and iPod Classic (older models such as iPod Mini do not support this feature).

1. Make sure your iPhone or iPod is properly docked. Press the **time sync/time set Button** located at the back of the unit. "SYNC" will appear on the display, indicating sync function is in progress.
2. After sync is complete, the display will show the current time and date on your iPhone/iPod clock and two beeps will confirm time sync is done.
3. If time sync fails, 2 second long beep sounds and the unit exits time sync mode. Try syncing again, or set time and calendar manually (see below).

NOTE: The iPhone is constantly updated to current time via cell phone towers. The time on your iPod is only accurate to the last time it was synced to a computer. It's possible to have up to 59 seconds difference between the iP39 and synced iPhone/iPod.

Setting Time and Calendar Manually

1. Set the **DST Switch** located on the back of the unit to +1 to add one hour or to -1 to subtract an hour to account for daylight saving time or standard time
2. Press and hold the **time sync/time set Button** located at the back of the unit until the time display flashes. Press the **◀** or **▶** button to set the correct time (press and hold for rapid advance). Remember to set the correct AM or PM time. The **PM Indicator** is located to the upper left side of the time digits; there is no AM indicator.
3. Press the **🕒 Alarm Button** at any time during clock setting to toggle the display between 24 hour (military) and 12 hour (standard) display mode.
4. Press the **time sync/time set Button**. The year will flash. Press the **◀** or **▶** button to set the current year.
5. Press the **time sync/time set Button**. The date will flash. Press the **◀** or **▶** button to select the current date (press and hold to enter fast scroll mode). The correct day will appear for the date set.
6. Press the **time sync/time set** again (or no button press within 10 seconds) to exit the clock setting mode.

Timer Operation

iP39 has 2 independent timers, a **quick timer** that lets you quickly set the timer in 1 minute steps and **Timer 2**, a normal timer which can be set in 5 minute increments. Both timers can run at the same time.

Setting the timers

1. Press the **quick timer/+1 min button** or the **timer 2/ +5 min button** to set the desired timer. Its icon and the timer digits will flash. Use the table below to set the desired countdown time in either timer mode while digits are flashing:



ACTION	BUTTON	RESULT
Press	quick timer + 1 min	+ 1 minute each press
Press	timer 2 + 5 min	+ 5 minute each press
Hold	quick timer or timer 2	+ 1 hour each second held
Press	◀ ▶	+/- 1 minute each press
Hold	◀ ▶	rapid scroll +/- minutes
Press	⏪ ⏩	+/- 1 second each press
Hold	⏪ ⏩	rapid scroll +/- seconds
Press	OFF	Cancel/end timer

Timer Operation

1. When no button is pressed for 2 sec. the timer is set. The lower part of the display will show current timer time.
2. Once the timer is set, it will start counting down over the set time period. Press the **OFF Button** at any time during timer setting to cancel the timer.
3. When the set time is up, the buzzer alarm will sound until you press the **OFF Button**. Or press the **quick timer/+1 min button** or **timer 2 +5 min button** to add additional time

Using the Alarm

Setting the Alarm

1. Press and hold the  **Alarm Button** until the alarm icon and alarm time flashes on the lower part of the display.
2. Press the **◀** or **▶** **Button** to set the desired alarm time. Remember to set the correct AM or PM alarm time (A or P next to alarm time indicates AM or PM alarm time).
3. Press the  **Alarm Button** to select wake to sound source. Press the **◀** or **▶** **Button** to cycle through Alert Modes: iPod/iPhone, FM radio or buzzer. You cannot wake to aux audio device.
4. Press the  **Alarm Button** (or no button within 10 seconds) to exit alarm setting mode. The alarm will be armed, indicated by the alarm icon

Note: If iPod/iPhone or FM radio alarm sounds and iP39 detects no sound for 30 seconds (or if no iPod/iPhone is detected or if AC power is unplugged), the buzzer will sound instead and iPod/iPhone will power down.

Review, Arming and Disarming Alarm (Turn Alarm Function On and Off)

To review the current alarm time and arm the alarm or to disarm the alarm, just press the  **Alarm Button** as needed. If the alarm is armed, the alarm icon and current alarm settings appear.

Resetting the Alarm to Come on the Next Day

When the alarm is sounding, press the **Off Button** to stop the alarm and cancel it. Press the  **Alarm Button** to stop alarm and reset it to come on the following day at the same time.

Sure Alarm

The iP39 has a sure alarm feature. If you have installed the backup battery, the buzzer alarm will still sound in the event of power failure.

Charging your iPod/iPhone and USB Device

Note: Please make sure you are using the correct insert for your iPhone/iPod and that it is properly docked into the iP39. Failure to do so may damage your iPhone/iPod.

While your iPhone/iPod is docked in the unit and the unit is connected to AC power, it recharges (until fully charged). Note that non-docking iPods will NOT charge.

Charging a USB Device

The iP39 is equipped with one USB 2.0 port (located on the the back apron) to charge most USB compatible devices such as cell phones or PDAs while the iP39 is connected to AC power.

To charge a USB-compatible device, lift the protective rubber cover from the USB port and insert the compatible USB charging cable (charging cable not included). Connect the other end to your device. Observe the charge indicator on your device to know when it is completely charged.

NOTE: Some devices specifically require a computer-connected USB port to charge

USB Mode Switch

Note: A USB Mode Switch is located on the back of the unit near the USB port. The USB Mode Switch is to address USB devices that require different bias to charge properly.

To use:

1. Connect your USB device to the USB charge port on the rear of the unit. Watch your device's charge indicator. If it charges properly, allow it to charge.
2. If the device does not charge, move the USB Mode Switch and again observe the device's charging indicator. If it charges properly, allow it to charge.

If your device does not charge in either of the two USB switch positions, the device may require connection to a powered USB port on a computer.

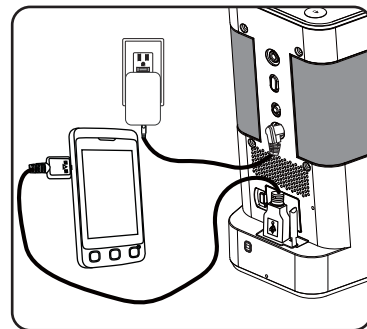

Listening to iPod/iPhone

1. Press on the slide out dock to access the dock and place the insert for your iPhone or iPod model. Gently insert an already playing iPhone or iPod. The iP39 will automatically turn on and you will hear the music playing from your iPod/iPhone.

Note: If the playing song/music loudness is too low on the iPod itself, the iP39 may not detect that the iPod/iPhone is in play mode. Press the **▶|| Button** to play it. If a timer is currently active, "iPod/iPhone" "on" will be displayed for 5 sec before returning to timer display. If no timers are active, "iPod/iPhone" "on" will be displayed while in "iPod/iPhone" mode.

2. Press the **◀◀ or ▶▶ Button** to change iPod/iPhone track forward/reverse.
3. When the iPhone/iPod is docked and in standby mode, press the **▶|| Button** to play it.
4. When the iPhone or iPod is in play mode, press the **▶|| Button** again to pause play; press again to resume it.
5. Press the **Volume ◀||) or ◀) Button** to adjust the iP39 volume.
6. To turn off the unit, press the **OFF button**. Your iPhone/iPod will continue charging while in the dock.

Note: While listening to iPod/iPhone, if iP39 has no power (AC adaptor not plugged in) the iPod/iPhone will POWER OFF.

Listening to FM Radio

Setting up the Antenna

Extend the wire antenna fully for best reception. Do not strip, alter or attach to other antennas.

Tuning and Playing the Radio

1. Press the **radio/aux. in Button** as needed to turn on the iP39 and cycle to FM Radio mode. The middle part of the display will show “FM” and the lower part of the display will show the currently playing station frequency.
2. Press the **◀◀ or ▶▶ Button** to tune radio to a desired station. Press and hold the **◀◀ or ▶▶ Button** briefly to seek the next clear FM radio station. Holding **◀◀ or ▶▶ Button** (2+seconds) will rapid scan as long as button is held.
3. Press the **◀▶) or ▶▶) Button** to adjust volume setting.
4. To turn off the unit, press the **OFF Button**. iPhone/iPod will continue charging while in the dock.

Setting FM Radio Frequency/Range to Use iP39 in Other Countries

Different regions of the world use different FM radio frequency steps and ranges. You will need to select the one that matches the standards in your region (USA, EUROPE, JAPAN, AUSTRALIA, or CHINA). The default setting is USA; if you live in the US, you may skip this section.

1. Make sure the iP39 is OFF (not playing in any mode). Press and hold the **Radio/aux Button** for about 5 seconds until “FM” flashes in the lower part of the display. Press the **◀◀ or ▶▶ Button** to select your region (EU=Europe, JPN= Japan, AUS=Australia, CHN= China).
2. Press the **Radio/aux Button** again (or no button within 5 seconds) to exit the radio frequency setting mode.

Using the Aux Line-In Jack with Other Audio Devices

The iP39 has an aux line-in jack that lets you play other audio devices through it.

1. Plug one end of a standard 3.5mm audio patch cord (not included) into the headphone or line-out jack on your audio device and the other end of the patch cord into the iP39 aux line-in Jack, located on the rear of the unit.
2. Press the **radio/aux. in Button** until “AUX” appears in the middle part of the display, indicating aux mode is active.
3. Turn on and play your device (device must be controlled independently of the iP39).
4. Press the **Volume ◀▶) or ▶▶) Button** to adjust the system volume. Adjust the output volume on your device if needed.
5. To turn off the unit, press the **OFF Button**. Please remember to turn off your device, too.

Using Dimmer

1. When unit is not in an audio (radio, iPod or aux) or setting mode, press the **◀◀ or ▶▶ Button** to adjust LCD backlight brightness.

IMPORTANT SAFETY INSTRUCTIONS

When used in the directed manner, this unit has been designed and manufactured to assure your personal safety. However, improper use can result in potential electrical shock or fire hazards. Please read all safety and operating instructions carefully before installation and use. Keep these instructions handy for future reference. Take special note, and adhere to all warnings on the unit and in the instruction and service manual.

1. **Water and Moisture** – The unit should not be used near water. For example, near a bathtub, washbowl, kitchen sink, laundry tub, in a wet basement, or near a swimming pool, etc.
2. **Ventilation** – The unit should be situated so that its location or position does not interfere with its proper ventilation. For example, it should not be situated on a bed, sofa, rug, or similar surface that may block the ventilation openings; or placed in a built-in installation, such as bookcase or cabinet that may impede the flow of air through the ventilation openings.
3. **Heat** – The unit should be situated away from heat source such as radiators, heat register, stoves, or other appliances (including amplifiers) that produce heat.
4. **Power Sources** – The unit should be connected to a power supply only of the type described in the operating instructions or as marked on the appliance.
5. **Power Cord Protection** – Power supply cord should be routed so that they are not likely to be walked on or pinched by items placed upon or against them. It is always best to have a clear area from where the cord exits the unit to where it is plugged into an AC outlet.
6. **Cleaning** – The unit should be cleaned only as recommended by the manufacturer.
7. **Object and Liquid Entry** – Care should be taken so that objects do not fall and liquids are not spilled into the enclosure through openings.
8. **Attachments** – Do not use attachments not recommended by the product manufacturer.
9. **Lightning and Power Surge Protection** – Unplug the unit from the wall outlet and disconnect the antenna or cable system during a lightning storm or when it is left unattended and unused for long periods of time. This will prevent damage to the product due to lightning and power-line surges.
10. **Overloading** – Do not overload wall outlets, extension cords, or integral convenience receptacles as this can result in a risk of fire or electric shock.
11. **Damage Requiring Service** – The appliance should be serviced by qualified service personnel when:
 - A. The power-supply cord or plug has been damaged.
 - B. Objects have fallen into or liquid has been spilled into the enclosure.
 - C. The unit has been exposed to rain.
 - D. The unit has been dropped or the enclosure damaged.
 - E. The unit exhibits a marked change in performance or does not operate normally.
12. **Antenna** – Do not connect an external antenna to the unit (other than that provided).
13. **Periods of Nonuse** – If the unit is to be left unused for an extended period of time, such as a month or longer, the power cord should be unplugged and take out batteries from the unit to prevent damage or corrosion.
14. **Servicing** – The user should not attempt to service the unit beyond that described in the user's operating instructions. All other servicing should be referred to qualified service personnel.

Troubleshooting

Symptom	Possible Problem	Solution
Unit doesn't respond (no power)	AC adaptor isn't plugged to a wall outlet or the connector is not plugged into the power supply jack on the back of the unit	Plug the AC adaptor into a wall outlet and plug the connector into the supply jack on the unit
	Wall outlet is not functioning	Plug another device into a wall outlet (same outlet) to confirm the outlet is working
iPod/iPhone does not dock properly	Using no or wrong iPod/iPhone insert	Make sure the dock insert is the proper fit to your iPod/iPhone
	iPod/iPhone is obstructed	Remove your iPod/iPhone from the dock and check for obstruction on the connectors in the dock and on your iPod. Then reseat it in the dock.
iPod/iPhone does not respond to the unit	iPod/iPhone is not docked properly	Remove your iPod/iPhone from the dock and check for obstruction on the connectors in the dock and on your iPod. Then reseat it in the dock.
	Your iPod/iPhone software is too old	Upgrade software on your iPod/iPhone via iTunes
	iPod/iPhone is locked up	Please make sure your iPod/iPhone is working properly before dock into the unit. Please refer to your iPod manual for detail.
	Using 3 rd generation iPod	iP39 doesn't support 3 rd generation iPod
iPod/iPhone didn't charge up	iPod/iPhone is not docked properly	Remove your iPod/iPhone from the dock and check for obstruction on the connectors in the dock and on your iPod/iPhone. Then reseat it in the dock.
	iPod/iPhone is locked up/frozen	Please make sure your iPod/iPhone is working properly before dock into the unit. Please refer to your iPod manual for detail.
	iPod/iPhone battery has problem	
Sound is distorted	Volume level is set too high	Decrease the volume.
	Sound source is distorted	If iPod/iPhone original sound source is poor quality, distortion and noise are easily noticed with high-power speakers. Try a different audio source such as a music CD via line-in.
		If you are using an iPod Shuffle or external sound source like older generation iPod, try reducing the output volume on the device itself. Also, try turning bass boost OFF.
Remote control doesn't work	Battery is weak or dead	Replace with new battery
	Remote Control is not pointed toward the IR window	Point the Remote Control toward the unit IR window, use within 10 feet of the unit.

© 2010 SDI Technologies, Inc. All rights reserved

Questions? Visit www.ihomeintl.com